

TRAVEL ADVISOR SALES GUIDE





Dear Travel Advisor Partner,

There's a whisper of adventure on the horizon—a promise of untouched landscapes, hidden cultures, and moments that shift perspective. We invite your clients to see the world through a new lens, guided by the spirit of discovery and a deep respect for the places and people they'll encounter.

Our fleet of 12 ultramodern, intimate ships is designed for those who seek more than a destination—they seek meaning from their travel experiences. PONANT EXPLORATIONS glides into remote harbors and untouched coves where larger vessels can't follow, with more than 400 awe-inspiring voyages. And in most voyages, guests are immersed in the heart of the experience, accompanied by expert naturalists, historians, and cultural guides who bring each destination to life.

On board, the elegance is effortless. Refined service, exquisite cuisine, and thoughtful touches create a seamless backdrop to every adventure. It's luxury not as a statement, but as a full sensory experience.

Discover what makes PONANT EXPLORATIONS a leader in luxury expedition by using this Sales Guide as you reference. Through the pages you will find links with resources to help you further understand the product and experiences offered, plus co-branded marketing pages you can customize and share with your clients.

With so much to offer, our foremost priority is supporting you to transform our refined adventures into remarkable experiences for your most discerning clients.

In Partnership,

Samuel Chamberlain
*Chief Executive Officer,
Americas*





Contents

Worldwide Explorations	2
10 Reasons to Book Your Clients	4
All-Inclusive Luxury.....	7
Beyond Green	8
PONANT EXPLORATIONS Science	9
Guest Profile.....	10
Award-Winning Excellence	12
Curated Voyages	13
Smithsonian Journeys	14
The Explorers Club.....	16
WHOI.....	17
Our Fleet	18
The PONANT Explorers	20
The Sisterships	24
<i>Le Commandant Charcot</i>	28
PONANT YACHTING	34
Paul Gauguin Cruises	35
Services Aboard.....	36
Excursions and Explorations	39
Tools For Our Partners	40
Groups.....	42
Special Offers	44
Frequently Asked Questions.....	45
Sales Contacts	48

WORLDWIDE EXPLORATIONS

with PONANT EXPLORATIONS

Greenland Sea

GREENLAND

Polar Arctic Circle

Nuuk

CANADA

Labrador Sea

NORTH AMERICA

Saint Lawrence River

Québec
Montréal

MEXICO

Sea of Cortez

Pacific Ocean

POLYNESIA

Marquesas Islands
Society Islands
Papeete
Tuamotu
Fakarava
Gambier Islands
FIJI
Lautoka
COOK ISLANDS
Austral Islands
Rarotonga
Rurutu
FRENCH POLYNESIA
PITCAIRN

CARIBBEAN AND CENTRAL AMERICA

Caribbean Sea
Colón
COSTA RICA
PANAMA
Panama Canal
GUADELOUPE
Pointe-à-Pitre
Fort-de-France
MARTINIQUE
SAINT-VINCENT AND THE GRENADINES
CAPE VERDE

ATLANTIC ISLANDS

Atlantic Ocean

SOUTH AMERICA

Rio de Janeiro
BRAZIL
Valparaíso
URUGUAY
Montevideo
Buenos Aires
CHILE
Valdés Peninsula
ARGENTINA
FALKLAND ISLANDS
SOUTH GEORGIA
Strait of Magellan
Ushuaia
Cape Horn
Drake Passage
SOUTH SHETLANDS
ANTARCTIC PENINSULA

ANTARCTICA

Southern Ocean

Antarctic Circle

Weddell Sea

Ross Sea

Scan QR code
to see Sailing
Schedules



Antarctic Circle

Ross Sea

HIGHLIGHTS

New ports of call

UNESCO Sites

Hiking

Iconic fauna in polar regions

Dogsledding

Diving

Iconic fauna in tropical regions

Sea kayak

Northern Lights

Communities in polar and tropical regions



10 REASONS

to Book Your Clients on
PONANT EXPLORATIONS



The Art of French Hospitality

Our French heritage is reflected in every detail—from the refined service to the warm, multilingual crew—ensuring an experience that is both attentive and discreet.



Scan QR code
to watch a video about
life on board the ships

Effortless Elegance

PONANT EXPLORATIONS blends understated luxury with French-inspired cuisine, fine wines, and chic design—creating an ambiance that feels both sophisticated and relaxed.





3

All-Inclusive, No Surprises

Every voyage includes gourmet dining; open bar; gratuities; port taxes and fees; 24-hour room service; Wi-Fi; enrichment programs; and access to wellness areas. One included excursion per port of call is also standard, with naturalist-guided tours and Zodiac landings included on expeditions.



5

Exclusive Curated Voyages

Expert-led journeys include alliances with **Smithsonian Journeys**, **The Explorers Club**, and **Woods Hole Oceanographic Institution** offering specialized insights and exclusive access.

Small Ships, Big Adventures

With a fleet of 12 small, agile ships, PONANT EXPLORATIONS sails where larger vessels can't—navigating remote waterways and hidden coves for an intimate, immersive experience.



4

Journeys That Go Deeper

Each itinerary is crafted to offer meaningful encounters with wildlife, landscapes, and cultures, led by a team of passionate experts—naturalists, historians, artists, and scientists—who bring every destination to life.



6



7

A Culinary Experience Curated by Ducasse Conseil

From delicious breakfasts and à la carte dishes to homemade pastries and luxury tastings (like pata negra and caviar), every meal is a refined surprise prepared and baked fresh on board.

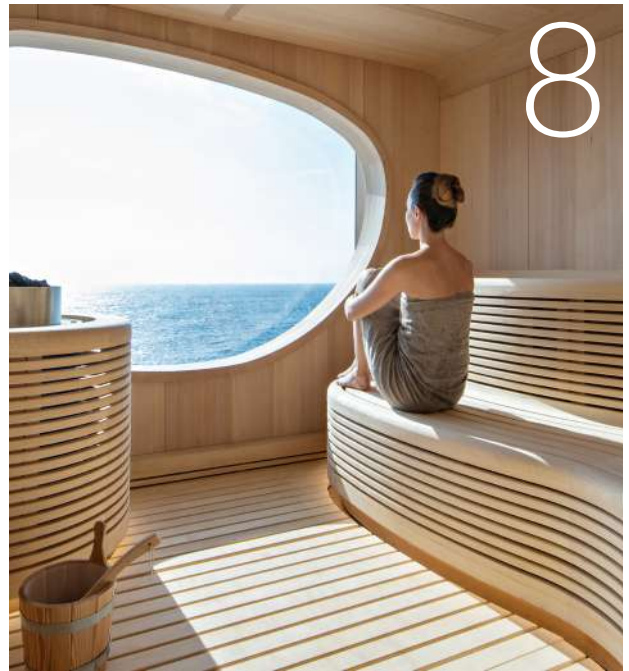

8

Wellness and Entertainment at Sea

On board, guests can enjoy live music, a pool (except on *Le Ponant*), and serene wellness areas with fitness rooms and spas featuring treatments by Clarins, Biologique Recherche, and Sothys. The onboard theatre hosts lectures, films, and performances to enrich the experience, and guests enjoy live music in the lounges every evening.



9

Sailing Under the French Flag

PONANT EXPLORATIONS is one of the few cruise lines to sail under the French flag—a guarantee of the highest standards of safety, crew training, and health protocols.

Committed to Sustainability

PONANT EXPLORATIONS leads the way in eco-friendly cruising, with ships equipped with the latest technology to minimize environmental impact and a strong commitment to global sustainability initiatives.



10

ALL-INCLUSIVE LUXURY

On every PONANT EXPLORATIONS voyage guests enjoy the following all-inclusive amenities:

- All gourmet meals aboard ship, featuring French-inspired cuisine created in collaboration with Ducasse Conseil
- Open bar with select wine, champagne, beer, and liquor
- 24-hour room service
- Unlimited Wi-Fi through the ship
- Gratuities to onboard crew, local guides, and drivers
- Shore excursion or activity in each port of call
- Zodiac cruising or landings on expeditions
- Port taxes and fees
- Captain's welcome and farewell cocktail parties
- One Gala Dinner
- Evening entertainment and events
- Baggage handling from pier to the ship and vice versa
- Park entry fees into protected areas

On select sailings, lecturers, guides, naturalists, expedition leaders, special themes, charter flights, and transfers may be included. Visit us.ponant.com to discover what's included on each voyage.

For polar expeditions, we go the extra mile by offering a **complimentary parka** to keep, and guests have the opportunity to **borrow polar boots** while onboard to ensure their comfort.

All fares are inclusive of up to 30% PONANT Bonus Savings. The earlier you book your clients, the more they save.

Solo travelers, family and friends, adventurers embarking on back-to-back voyages, those traveling as part of the referral program: there are plenty of benefits for every guest. From the second cruise onwards, guests can join our loyalty program, the PONANT Yacht Club, and enjoy exclusive services and great savings.

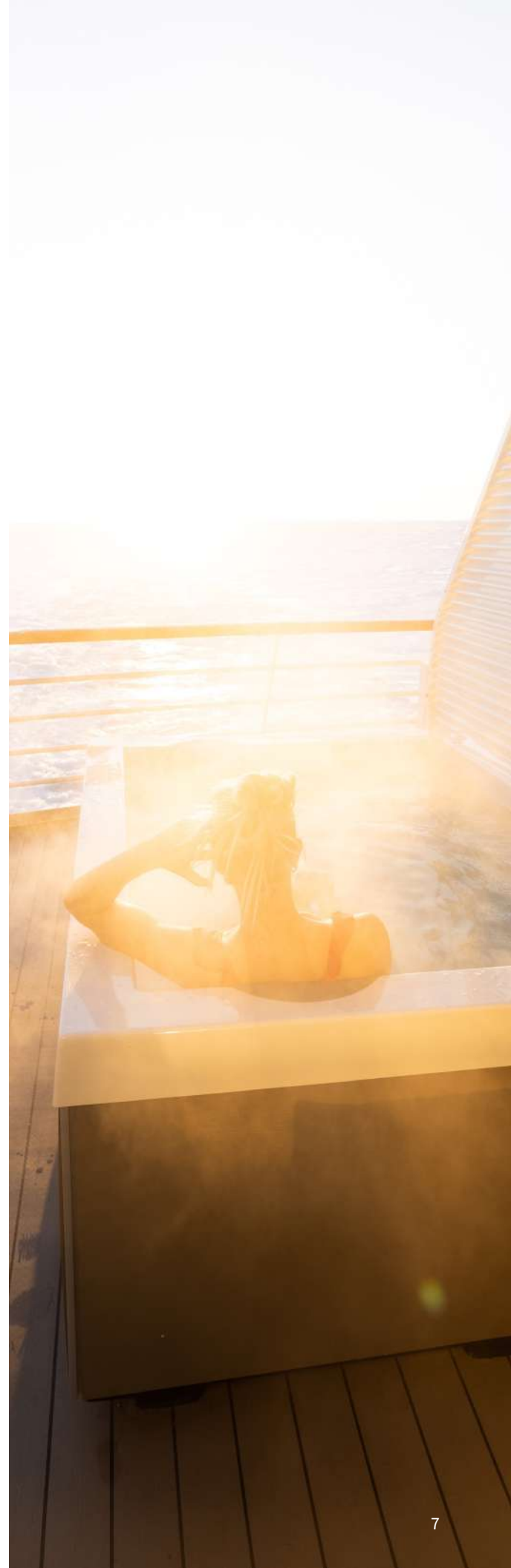



BEYOND GREEN

Purpose-built for more responsible exploration, PONANT EXPLORATIONS ships feature the latest technologies and, in many areas, exceed the industry's highest environmental standards. Each of the Sisterships, PONANT Explorer Series, and the Icebreaker *Le Commandant Charcot* is certified "Clean Ships" by Bureau Veritas, one of the world's foremost stewards of ecologically sound travel.

Our commitment for a more sustainable tourism includes a strategy to optimize environmental performance and ensure we can:

- cut carbon emissions by 40% with a silent electric propulsion system.
- keep in a fixed location on the seas without need of an anchor with a sophisticated GPS and propulsion system, called Dynamic Positioning.
- conserve, filter, treat, and recycle all water used.
- treat wastewater with advanced filtration systems.
- sort, compact, and store all waste aboard for recycling ashore.
- use CFR and LED lighting throughout ships, which uses 10% of the electrical power of older systems.
- keep distance from marine animals via advanced sonar that provides the bridge with rolling 3D views of the ocean floor, icebergs, and ice floes.

SUPPORTING SCIENCE AT SEA

PONANT EXPLORATIONS actively supports scientific research, facilitating projects and providing our vessels in some of the most inaccessible regions of the globe, especially in the polar areas.

This support has led to the development of numerous studies across a wide range of disciplines, from geophysics to ecology and marine pollution. Thanks to our regular presence in the Arctic and Antarctic, PONANT EXPLORATIONS has become a vital link between science and the poles.

Through PONANT Science, researchers from around the world embark our ships to study the ocean—Earth's least understood ecosystem. With two onboard labs and rare polar access, *Le Commandant Charcot* enables vital work in regions once considered unreachable. Travel and science move forward together.



Scan QR code to learn more.
PONANT EXPLORATIONS
Explore to Understand





GUEST PROFILE

The PONANT EXPLORATIONS guest is more than a traveler. They're a seeker. Well-traveled, intellectually curious, and culturally engaged, they want more than just a vacation. They crave experiences that are immersive, meaningful, and deeply personal. Affluent and internationally experienced, most PONANT EXPLORATIONS guests are semi- or fully-retired professionals—entrepreneurs, executives, and high-net-worth individuals—who value both adventure and elegance. They're global citizens with a sophisticated palate for gastronomy, fine wines, art, and music, and a deep appreciation for culture and history.

All PONANT EXPLORATIONS guests share a thirst for discovery and a desire for excellence—in service, in comfort, and in experience. For them, travel isn't about checking off destinations, it's about transforming how they see the world.



GUEST DEMOGRAPHICS

WHO THEY ARE

- **Net Worth** \$2M+ (Avg. \$2.9M)
- **Median Household Income** \$250K+
- **Age** 55+ (Avg. 71)
- **Primarily Couples** 20% are solo travelers
- **Educated and Cultured** Entrepreneurs, executives, and professionals with a global outlook
- **International** Booking via our offices in New York City, Sydney, London, Hamburg, and Marseille; guests onboard enjoy our sophisticated multi-cultural atmosphere.

WHAT DRIVES THEM

- **Exploration Seekers** Gravitate toward expedition cruises, cultural activities, and wildlife adventures
- **Active Travelers** Seek active adventures through hiking, kayaking, Zodiac exploration, and nature activities
- **Culturally Curious** History buffs and art lovers who'll seek out expert-led travel
- **Luxury Seekers** Yacht-style voyagers who value personalized service and elegance
- **Milestone Events** Celebratory journeys and exclusive gatherings
- **Solo Travelers** Seeking refined, comfortable, and engaging atmospheres

HOW THEY ENGAGE

- **Media** Internet-first; Facebook is the dominant social platform
- **Entertainment** 3 out of 4 watch TV daily—especially Netflix
- **Interests** Home improvement, financial investments, travel, arts, philanthropy, and political engagement





AWARD-WINNING EXCELLENCE

Awards are gratifying, but they're not the goal—they're a reflection of the care and craft that define every PONANT EXPLORATIONS journey. Each honor reflects our commitment to creating seamless, immersive experiences for your clients—on board and ashore. When you recommend PONANT EXPLORATIONS, you're connecting your clients to the very best in luxury exploration.

Recent Accolades:

- Best Itineraries and Best in the Arctic among the Expedition category—2025 Cruise Critic's 17th Annual Best in Cruise Awards
- 2025 Best Expedition Cruise Experience by Virtuoso
- Best Expedition Ship by Porthole Cruise and Travel 2025 Readers; Choice Awards (*Le Commandant Charcot*)
- Luxury, Adventure, Innovation — Forbes Travel Guide's 2025 The Edge List by RIMOWA (*Le Commandant Charcot*)
- Best in the Arctic & Best Itineraries (Expedition Category) — Cruise Critic's "Best in Cruise" Awards 2024
- Best Adventure Cruise Line — Global Traveler's 2024 Leisure Lifestyle Awards
- Best Expedition Cruises — Global Traveler's 2024 Leisure Lifestyle Awards
- Sustainability, Inclusion, Responsible Travel — Afar Travel Vanguard Awards 2024
- Innovative Shorex of the Year — Seatrade Cruise Awards 2024 (East Greenland Expedition)
- #1 in Best Adventure Cruise & Special Achievement Award - Outstanding Social Responsibility honor — Global Travelers Leisure Lifestyle Award 2024
- Best Arctic Adventure — GOTHAM Magazine Modern Luxury's inaugural Travel Awards 2024 (*Le Commandant Charcot*)

When your clients choose to sail with PONANT EXPLORATIONS, they are on a cruise line trusted and celebrated by the world's top travel authorities.





CURATED VOYAGES

At PONANT EXPLORATIONS, we believe that travel—when approached with curiosity and care—has the power to transform not only the traveler, but the world. Our voyages go beyond boundaries, and beyond the expected. Whether tracing ancient trade routes, engaging with global experts, or immersing in natural and cultural wonders, our journeys are designed to inspire, enlighten, and inform. Each season, we craft inspiring journeys designed to offer truly unique experiences. These are enriched by the expertise of our esteemed partners and alliances, represented on board by inspiring figures — artists, historians, curators, researchers, journalists, essayists, and more.

Expert-Led Voyages Themes:

- Explorations
- Culture
- Art of Living
- Society & Planet
- Alliances



A SHARED PASSION FOR DISCOVERY

In 2022, PONANT EXPLORATIONS and **Smithsonian Journeys** came together to form an **alliance**, a collaboration specially created for the refined traveler seeking a journey of exploration and cultural immersion.

On these voyages, we are joined by **two Smithsonian Journeys Experts** who will provide an insightful lecture series that enhances the experience with valuable context and new perspectives.

These extraordinary individuals include the likes of archaeologists, art historians, conservationists, renowned cultural scholars, geologists, and many more. From enriching talks to casual conversations on board, their **in-depth knowledge** brings guests deeper into the history, culture, and natural world of each destination.

The name of the Smithsonian and the sunburst logo are registered trademarks of the Smithsonian Institution, and PONANT EXPLORATIONS is an authorized user.



EACH DEPARTURE INCLUDES:

- **Engaging lectures and discussions** on board provided by **two knowledgeable Smithsonian Journeys Experts**, selected for their expertise in history, art, the natural world, or other topics relevant to the destinations
- **A PONANT Travel Director**
- **One included shore excursion or activity** in each port of call
- **All meals and open bar** aboard ship
- **24-hour** room service
- **Complimentary Wi-Fi** aboard ship
- **Gratuities** to shipboard personnel, porters, guides, and drivers
- **Transfers** from the airport to the ship on embarkation day, and from the ship to the airport on disembarkation day

WHAT MAKES THE SMITHSONIAN JOURNEYS EXPERT SPECIAL

- Chosen for **expertise** and engaging **storytelling**
- **Lectures and informal talks** related to the destination of the itinerary
- **Open discussion** and deeper **exploration**

Where traditional PONANT EXPLORATIONS voyages are operated in both French and English, the departures in alliance with Smithsonian Journeys are curated especially for **English-speaking travelers** while showcasing the company's signature French flair in onboard delivery and service.

Select Expert-Led Themed Voyages are also operated only in English. Visit us.ponant.com for more details.

Scan QR code to learn more and share with your clients.





+ **THE EXPLORERS CLUB**

AN ALLIANCE OF UNPRECEDENTED DISCOVERY

Since its founding in 1904 by some of the world's leading explorers, **The Explorers Club** has been at the forefront of humanity's greatest achievements—from reaching the North and South Poles to scaling Everest, diving to the ocean's depths, and walking on the moon. Among its legendary members are **Neil Armstrong, Jane Goodall, Edmund Hillary, and Roald Amundsen.**

Through its alliance with **PONANT EXPLORATIONS**, The Explorers Club brings a spirit of discovery and research to sea. These voyages to some of the planet's most remote corners feature exclusive onboard programs that connect guests directly with exploration's modern pioneers.

HIGHLIGHTS INCLUDE:

- **Engaging lecture series hosted by esteemed members of The Explorers Club**—sharing captivating stories of adventure, discovery, and scientific innovation.
- **Opportunities to meet Explorers Club Science Grantees** aboard *Le Commandant Charcot*, who utilize the ship's dedicated research laboratories and share firsthand insights from their ongoing work.



Scan QR code to learn more and share with your clients.

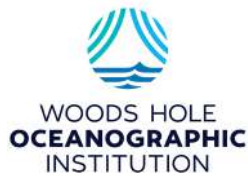

THE GREAT MINDS OF THE OCEAN SCIENCES

Founded in 1930, **Woods Hole Oceanographic Institution (WHOI)** is among the world's leading centers for marine science and innovation. From discovering species at deep-sea vents to exploring the Titanic, WHOI has shaped how we understand—and protect—Earth's last true frontier: the ocean.

On select voyages, WHOI scientists come aboard to share their research on ocean currents, climate change, and marine biodiversity. Guests enjoy access to groundbreaking science, with opportunities for meaningful interaction and conversation.

Together, we transform our explorations into something deeper, a front-row seat to discovery and a chance to engage with the planet's most vital ecosystems, guided by those who dedicate their lives to studying and safeguarding the sea.



Scan QR code to learn more.

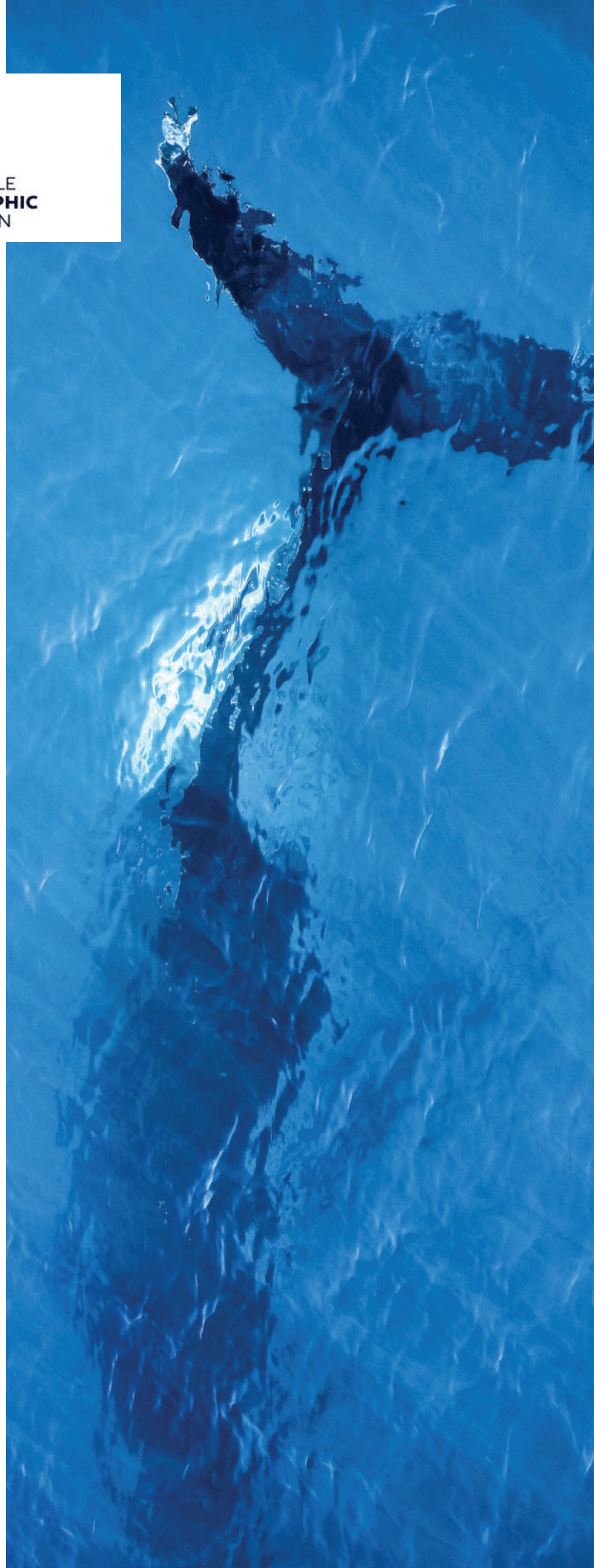



OUR FLEET

Aboard a fleet of 12 French-flagged small ships, fitted with the latest environmental technologies, the journey of exploration is always elegant, authentic, and inspiring. Purpose-built for navigating remote destinations and smaller ports, these sleek small ships combine cutting-edge design with the elegance and intimacy of a private vessel. The result is a seamless blend of comfort and access—ideal for clients seeking adventure without sacrificing refinement.



PONANT EXPLORERS

Le Bellot, Le Bougainville, Le Champlain, Le Dumont d'Urville, Le Jacques Cartier, Le Lapérouse

- 92 staterooms and suites
- Up to 184 guests (1:1.5 crew-to-guest ratio)
- Main Lounge - Seating capacity: 184
- *Blue Eye* Underwater Lounge - Seating capacity: 40
- Infinity Pool
- Observatory Lounge
- Panoramic Restaurant - Seating capacity: 184
- Outdoor Grill Restaurant - Seating capacity: 70
- Theater - Seating capacity: 184
- Adjustable Marina
(sundeck; submersible mini-marina; at water level)



LE COMMANDANT CHARCOT

- 123 staterooms and suites
- Up to 245 guests (1:1.1 crew-to-guest ratio)
- Main Lounge
- Panoramic Bar and Lounge - Seating capacity: 88
- Gastronomic Restaurant - Seating capacity: 284
- Grill Restaurant - Seating capacity: 150 (inside); 62 (outside grill); 70 (outside lido)
- Theater - Seating capacity: 270
- Indoor and Outdoor Pools



SISTERSHIPS

L'Austral, Le Boréal, Le Soléal

- 132 staterooms and suites
- Up to 264 guests (1:1.8 crew-to-guest ratio)

Le Lyrial

- 122 staterooms and suites
- Up to 244 guests (1:1.6 crew-to-guest ratio)
- Main Lounge - Seating capacity: 110 (inside); 30 (outside)
- Panoramic Lounge - Seating capacity: 30
- Open-air Bar - Seating capacity: 50
- Gastronomic Restaurant - Seating capacity: 268
- Grill Restaurant - Seating capacity: 150 (inside); 60 (outside)
- Theater - Seating capacity: 250



SAILING SHIP

Perfect for Groups and Charters

Le Ponant

- 16 staterooms and suites
- Up to 32 guests (1:1 crew-to-guest ratio)

Scan the QR code
to learn more about *Le Ponant*
and share with your clients.



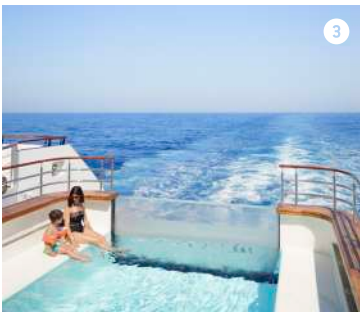

The PONANT Explorers

*Le Bellot, Le Bougainville, Le Champlain,
Le Dumont d'Urville, Le Jacques Cartier & Le Lapérouse*

At 430 feet in length, these intimate vessels accommodate up to 184 guests, offering a 1:1.5 crew-to-guest ratio and all-balcony staterooms and suites for uninterrupted ocean views. The PONANT Explorers combine cutting-edge design with elegant comfort, featuring refined accommodations and inviting lounge areas that connect seamlessly to the sea. Exclusive to PONANT EXPLORATIONS, the Blue Eye Lounge is an underwater panoramic lounge, a world-first in its design. Its bold architecture features sleek curves inspired by the underwater world. Beyond the exceptional experience of being below the waterline, the most mesmerizing aspect is watching the swirling currents through the portholes when the ship is sailing.

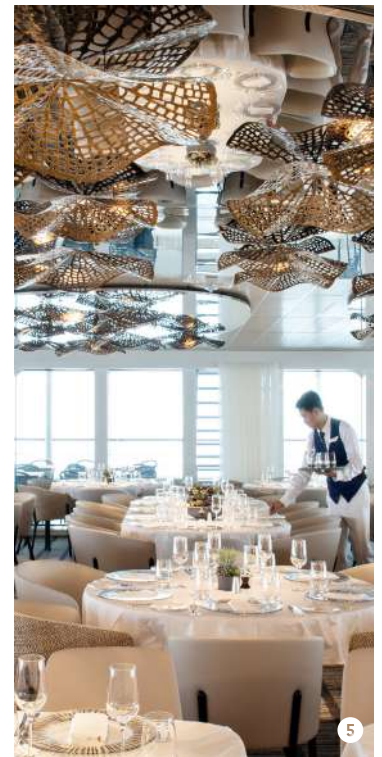

1. The Blue Eye, underwater lounge | 2. The Spa, in partnership with Sothys or Clarins | 3. The pool deck | 4. The Owner's Suite | 5. The panoramic restaurant, open to the outside | 6. The theatre, where lectures, shows, and performances take place | 7. *Le Bougainville* | 8. The Owner's Suite, its private terrace and hot tub | 9. Prestige Suite living room, *Le Lapérouse*



Ship Specifications

- Length..... 430 ft.
- Beam..... 59 ft.
- Draft..... 15 ft.
- Average cruising speed... 12.5 knots
- Ice Class..... 1C
- Classification..... Bureau Veritas
- Flag..... French
- Guest Decks..... 5
- Crew members..... 110
- Guest capacity..... up to 184 pax,
double occupancy
- Staterooms with balcony 86
- Suites with bay windows
and terrace..... 4
- Zodiacs..... (Mark V HD)
10 Zodiac craft
- Boston Whaler-type boats 1
- Gross tonnage..... 9,900 UMS
- Stabilizers (2)..... 13.1 ft. long x 4.7
ft. wide
- Construction..... VARD, Norway
- Delivery..... 2018

Public Areas

RECEPTION AREA

140 sq.m. - 1,507 sq.ft. - Reception/concierge desk, excursions desk, ship's administrative services, sales office, 50 sq.m. - 538 sq.ft. boutique.

MAIN LOUNGE

200 sq.m. - 2,153 sq.ft. which can accommodate all of our passengers to share convivial moments and to host activities organized during the day or evening.

BLUE EYE LOUNGE

Underwater panoramic lounge accommodating up to 40 guests.

RESTAURANTS

Grill Restaurant Capacity: 70 *Buffets - Grills*

Panoramic Restaurant Capacity: all guests
Buffet & table service opens to the outside

RECREATION / RELAXATION

- Hydraulic platform
 - Easier boarding
 - Easier Zodiac embarkation and disembarkation
 - Easier access to the sea for practicing various water sports such as kayaking
- Pool deck
 - Pool with a panoramic view, equipped with a counter-current swimming system
 - Solarium
 - Outdoor bar and lounge
- Theater
 - Capacity: 188
 - Main show room for conferences and live entertainment on selected evenings
 - State-of-the-art audio and video technology

Stateroom Amenities

- Exclusive, tailor-made services for guests in the Owner Suites, thanks to the assistance of our Concierge service
- Individually controlled air conditioning
- Stateroom layout: king-size bed, or twin beds, adjoining staterooms available (children welcome)
- Mini bar
- Flat-screen satellite TV
- Video on demand
- Bose Bluetooth speaker
- Safe
- Diptyque bath products
- Dressing table, bathrobes, hairdryer, slippers
- Direct line telephone
- 110V American (two flat pins)/220V European (round sockets with two round pins)
- 24-hour room service
- Inclusive Starlink Wifi internet access*

PONANT Explorers Accommodations

OWNER'S SUITE

45 sq.m. + 30 sq.m. private terrace with hot tub and sliding bay windows
 484 sq.ft. + 328 sq.ft. private terrace with hot tub and sliding bay windows



3 GRAND DELUXE SUITES

45 sq.m. + 30 sq.m. private terrace and sliding bay windows
 484 sq.ft. + 328 sq.ft. private terrace and sliding bay windows

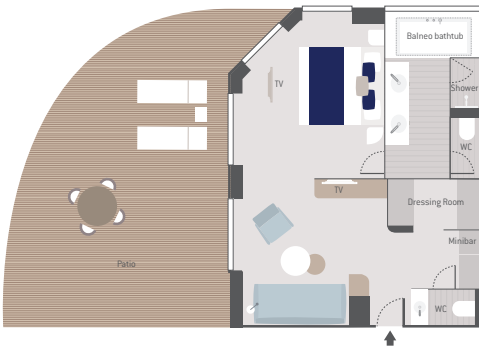

4 PRIVILEGE SUITES

32 sq.m. + 8 sq.m. private balcony with sliding bay window
 344 sq.ft. + 86 sq.ft. private balcony with sliding bay window



18 PRESTIGE SUITES

38 sq.m. + 8 sq.m. private balcony with sliding bay window
 409 sq.ft. + 86 sq.ft. private balcony with sliding bay window

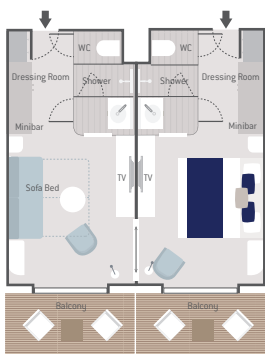

66 PRESTIGE STATEROOMS

19 sq.m. + 4 sq.m. private balcony with sliding bay window
 204 sq.ft. + 43 sq.ft. private balcony with sliding bay window



5 DELUXE SUITES

27.5 sq.m. + 6 sq.m. private balcony with sliding bay window
 291 sq.ft. + 65 sq.ft. private balcony with sliding bay window

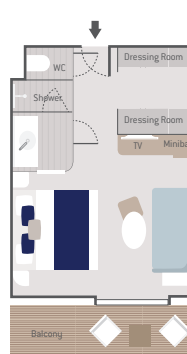

13 DELUXE STATEROOMS

19 sq.m. + 4 sq.m. private balcony with French window
 204 sq.ft. + 43 sq.ft. private balcony with French window



Prestige stateroom



Deluxe suite

PONANT Explorers Deck Plan

DECK 7

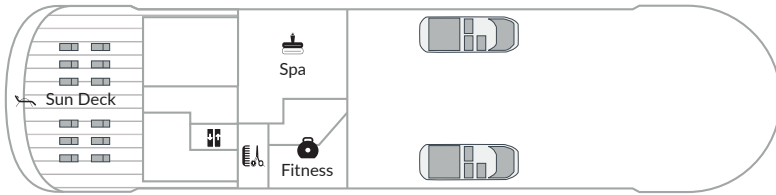

DECK 6

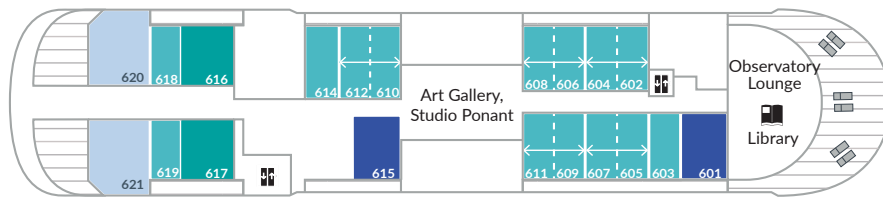

DECK 5

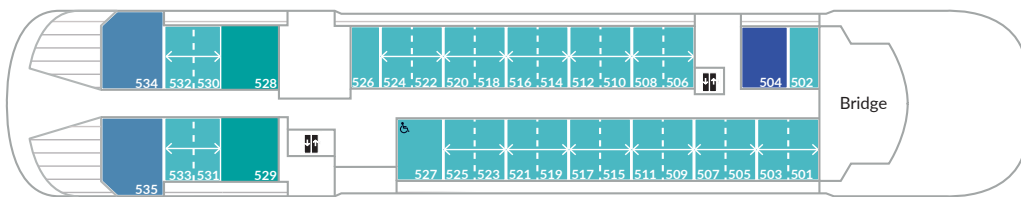

DECK 4

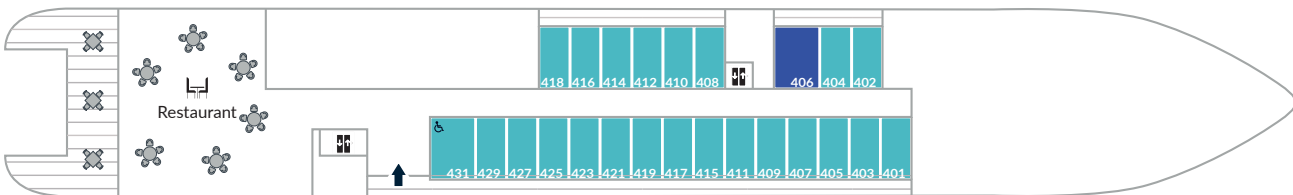

DECK 3

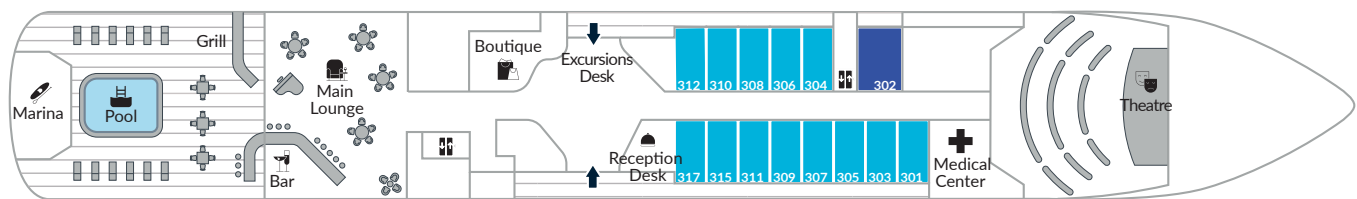

DECK 0 / The Blue Eye underwater lounge

- Deluxe Stateroom Deck 3
- Prestige Stateroom Decks 4-5-6
- Deluxe Suite Decks 3-4-5-6
- ↔ Prestige Suite Decks 5-6
- Privilege Suite Decks 5-6
- Grand Deluxe Suite Decks 5 - 6
- Owner's Suite Deck 6

Suites 431 and 527 are designated for guests with reduced mobility.



The Sisterships

L'Austral, Le Boréal, Le Lyrial & Le Soléal

PONANT EXPLORATIONS' four Sisterships embody the perfect balance of intimacy and elegance. With up to 130 staterooms and suites—95% of which feature private balconies—they offer an atmosphere of refined comfort and understated luxury. Designed in France and built in Italy, each ship reflects a unique color palette and motif while maintaining a shared aesthetic of European sophistication and craftsmanship. Discreet yet attentive service from the impeccably trained staff creates an atmosphere of relaxed elegance, capturing the essence of the French art of living well. Aboard the Sisterships, life feels effortless... like sailing on a private yacht among friends.

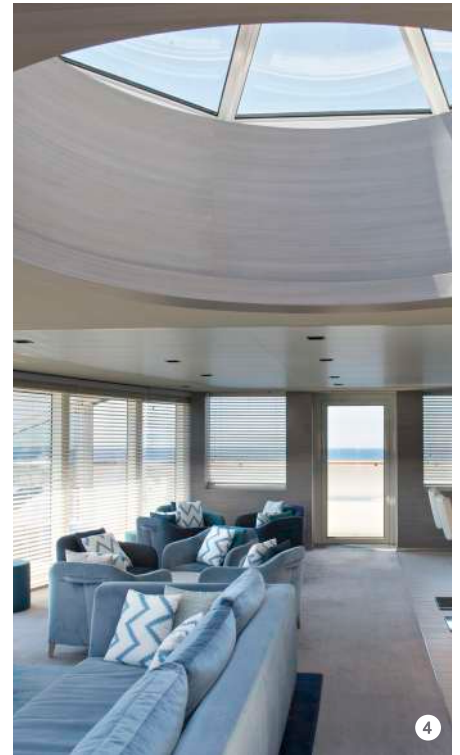

1. Spa, *Le Lyrial* | 2. The gastronomic Restaurant, *Le Lyrial* | 3. The swimming pool | 4. The Observatory lounge, *Le Boréal* | 5. The library | 6. *Le Boréal*
7. Prestige Stateroom, *Le Lyrial* | 8. Prestige Stateroom Balcony, *Le Boréal*

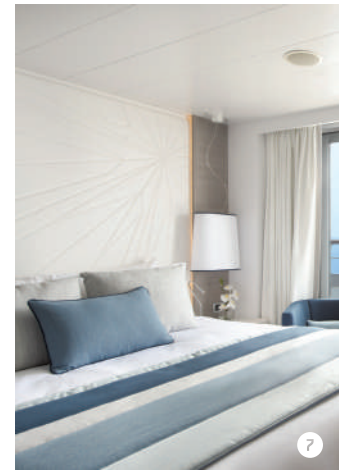

Ship Specifications

- Length..... 466 ft.
- Beam..... 59 ft.
- Draft..... 15.3 ft.
- Cruising Speed 14 knots
- Ice class 1 C
- Classification..... Bureau Veritas
- Flag French
- Guest Decks..... 6
- Guest capacity up to 264 pax (double occupancy) (up to 244 pax on *Le Lyrial*)
- Normal Crew Size... 140
- Zodiacs..... (Mark V HD) 12 Zodiac craft
- Gross tonnage..... 10,944 UMS
- Stabilizers (2)..... 13.1 ft. long x 4.7 ft. wide
- Electric motors 2 x 2,300 KW
- Installed power..... 6,400 KW
- Construction..... Fincantieri-Ancona, Italy
- Delivery 2010



Public Areas

LOBBY

1,453 sq.ft. / 135 sq.m. Concierge lounge including reception, customer relations and excursions desk, concierge service

RESTAURANTS

- Gastronomic Restaurant
3,982 sq.ft. / 370 sq.m.
Capacity: 268
Elegant main dining room for breakfast, lunch, and dinner, serving French and international cuisine, fine wine cellar
- Grill Restaurant
2,530 sq.ft. / 235 sq.m.
Inside capacity: 90
Outside capacity: 60
Casual eating venue for breakfast, buffet lunch, and dinner

LOUNGES

- Main Lounge
2,745 sq.ft. / 255 sq.m.
Inside capacity: 110
Outside capacity: 30
Afternoon tea, lounge, live music, dance floor, and cocktail bar
Access to the outside terrace
- Panoramic Lounge
1,184 sq.ft. / 110 sq.m.
Library, internet desk, cocktail bar, live entertainment on selected evenings
Direct access to the panoramic terrace
- Open-air Bar (Pool deck)
Seating: 50; Overlooking the pool deck

RECREATION / RELAXATION

- Theater
2,690 sq.ft. / 250 sq.m.
Capacity: 250
Main show room for conferences and live entertainment on selected evenings
State-of-the-art audio and video technology
- Fitness & Spa
Fitness room: Kinesis equipment, treadmills, bicycles
Sothys™ Spa: Hairdresser, Massage rooms (2), Balneo room, Hammam, Relaxation room
- Leisure area - Wii™ area, photo shop

Stateroom Amenities

- Exclusive, tailor-made services for guests in the Owner Suites, thanks to the assistance of our Concierge service
- Individually controlled air conditioning
- Stateroom layout: king-size bed, or twin beds, adjoining staterooms available (children welcome)
- Mini bar
- Flat-screen satellite TV
- Video on demand
- Bose Bluetooth speaker
- Safe
- Diptyque bath products
- Dressing table, bathrobes, hairdryer, slippers
- Direct line telephone
- 110V American (two flat pins)/220V European (round sockets with two round pins)
- 24-hour room service
- Inclusive Starlink Wifi internet access*

**Depending on the navigation areas, the Wifi may not be accessible for reasons beyond our control.*

The Sisterships Accommodations

L'Austral, Le Boréal, Le Lyréal, Le Soléal

OWNER'S SUITE aboard *Le Lyréal*

(55 sq.m/581 sq.ft + 12 sq.m/129 sq.ft private balcony with sliding bay windows)

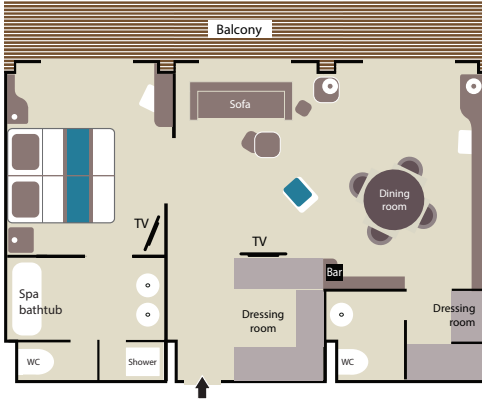

GRAND PRIVILEGE SUITE aboard *Le Lyréal*

(55 sq.m/581 sq.ft + 12 sq.m/129 sq.ft private balcony with sliding bay windows)

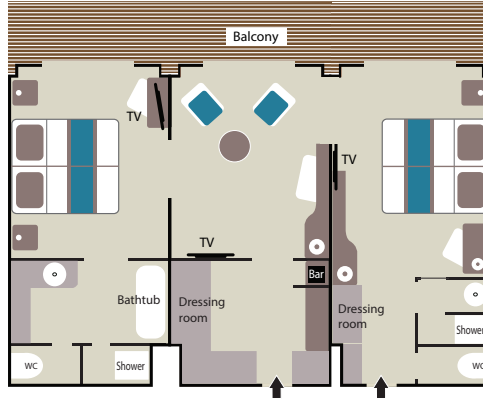

PRIVILEGE SUITE aboard *Le Lyréal*

(37 sq.m/388 sq.ft + 8 sq.m/86 sq.ft private balcony with sliding bay windows)

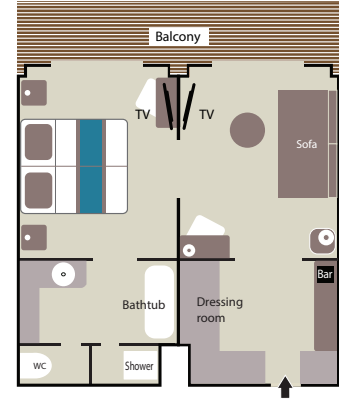

OWNER'S SUITE

(45 sq.m/484 sq.ft + 9 sq.m/97 sq.ft private balcony with sliding bay windows)

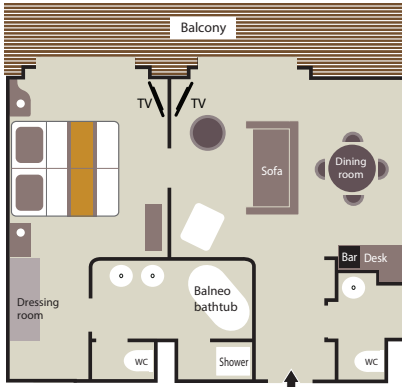

GRAND DELUXE SUITE aboard *Le Lyréal*

(45 sq.m/484 sq.ft + 10 sq.m/108 sq.ft private balcony with sliding bay windows)

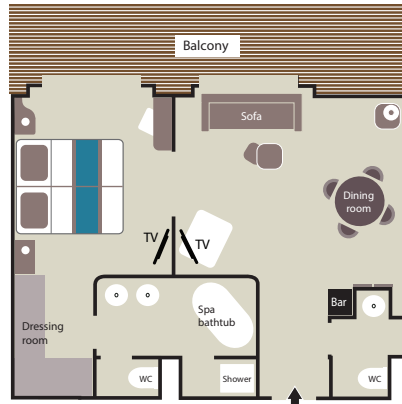

PRESTIGE SUITE

(37 sq.m/398 sq.ft + 8 sq.m/86 sq.ft private balcony with sliding bay windows)

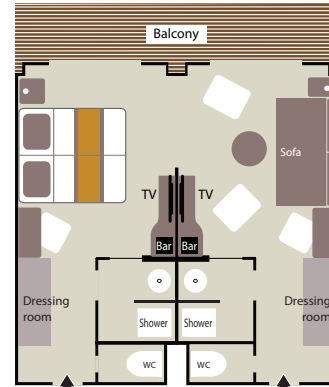

Prestige Suites aboard *Le Boréal* & *Le Soléal*: 1 shower and 1 bathtub.

DELUXE SUITE

(27 sq.m/290 sq.ft + 6 sq.m/64 sq.ft private balcony with sliding bay window)

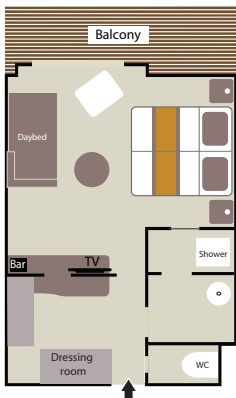

PRESTIGE STATEROOM

(18.5 sq.m/200 sq.ft + 4 sq.m/43 sq.ft private balcony with sliding bay window)

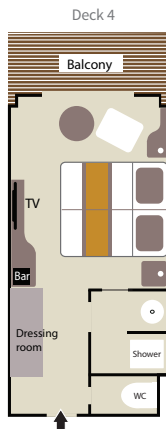

Deck 5-6

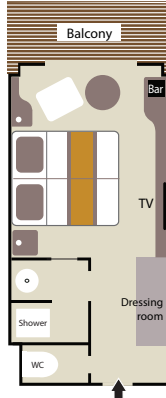

DELUXE STATEROOM

(18 sq.m/200 sq.ft + 4 sq.m/43 sq.ft private balcony with French window)

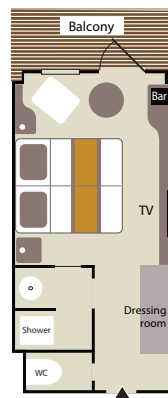

SUPERIOR STATEROOM

(21 sq.m/226 sq.ft)

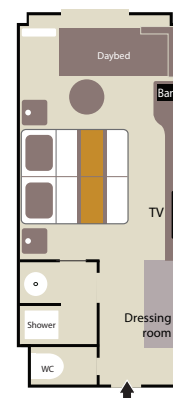

Deluxe Suites aboard *Le Boréal*: 1 shower and 1 bathtub

Prestige Staterooms aboard *Le Boréal* & *Le Soléal*, decks 5 & 6: 1 shower or bathtub depends on cabins

The Sisterships Deck Plan

DECK plans

DECK 7

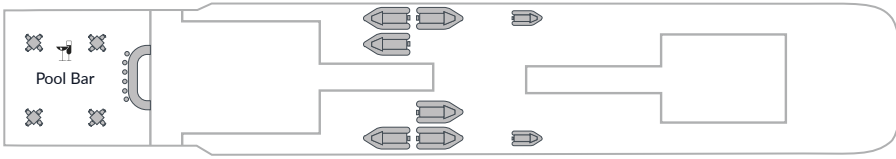

Suites 509, 407 and 307 are designated for guests with reduced mobility.

Aboard *Le Lyrial*, when not booked as a joint suite, 615 is a Prestige Stateroom and 611 is a Privilege Suite.

DECK 6

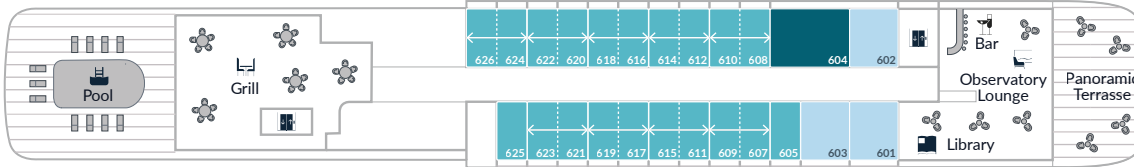

DECK 6 - *Le Lyrial*

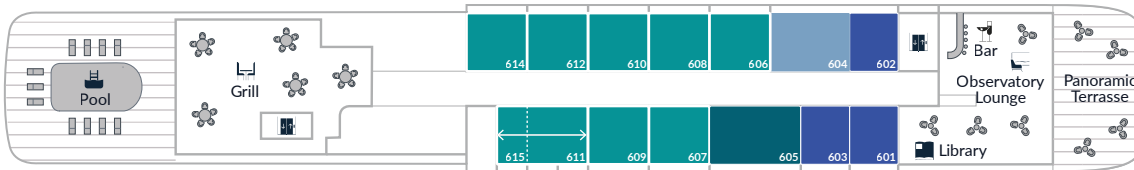

DECK 5

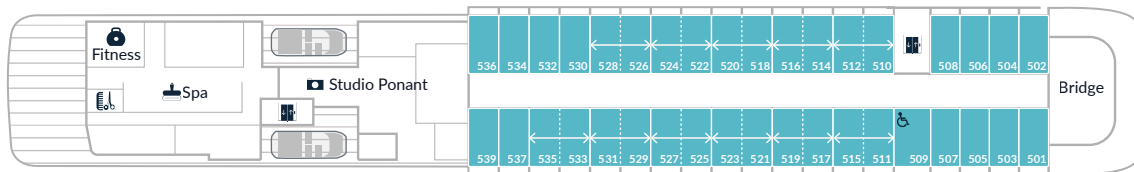

DECK 4

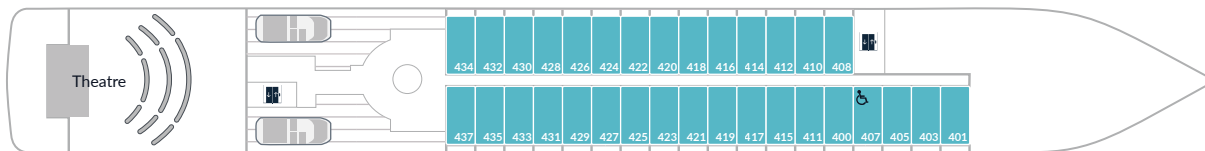

DECK 3

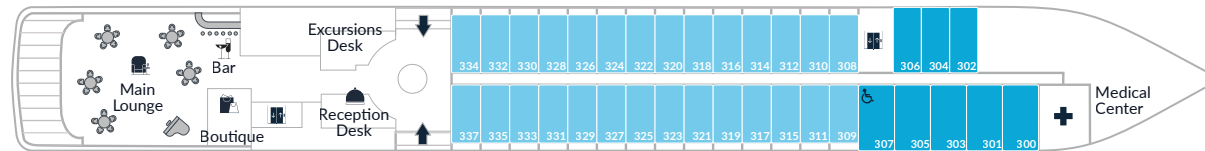

DECK 2



- Superior Staterooms
- Deluxe Stateroom
- Prestige Stateroom
- Deluxe Suite
- ↔ Prestige Suite
- Owner's Suite

Only on *Le Lyrial*: ● Privilege Suite ● Grand Deluxe Suite ↔ Grand Privilege Suite



Le Commandant Charcot

Le Commandant Charcot, the world's only luxury icebreaker is hybrid-electric and rated Super Clean. Powered by liquified natural gas (LNG) and electricity, *Le Commandant Charcot* is redefining polar exploration. Launched in 2021, this cutting-edge vessel offers guests the chance to follow in the wake of history's great polar explorers—while surrounded by unmatched luxury. From panoramic restaurants and full-width lounges to the promenade deck and lofty observation areas, every detail reflects PONANT EXPLORATIONS' vision of combining adventure with elegance. *Le Commandant Charcot* brings the most remote corners of the planet within reach, delivering an experience that is both pioneering and refined.



1. The sauna in the wellness area, which also includes the Biological Recherche Spa, hair and nail salon, fitness room, snow cabin

2. The relaxation area, with a heated indoor swimming pool and a detox bar

3. The Panoramic lounge, Deck 9

4. The lobby on *Le Commandant Charcot*

5. Nuna Gastronomic Restaurant, Alain Ducasse's only restaurant at sea

6. *Le Commandant Charcot*

7. The Owner's Suite patio, Deck 8

8. The sleeping area on the Duplex Suite

9. The Owner's Suite living room, Deck 8



6



7



8



9

Ship Specifications

- Staterooms and Suites with Balcony - 123 (including 32 suites with patio doors and a private balcony)
- Length 492 ft.
- Width 92 ft.
- Draught 33 ft.
- Ice class PC 2
- Propulsion..... LNG & Hybrid Electric
- Classification Bureau Veritas
- Flag..... French
- Crew members..... 235
- Passengers..... up to 245 max (double occupancy)
- Panoramic restaurant..... 1
- Grill restaurant..... 1
- Spa & Wellness center..... 1
- Onboard expedition Zodiacs..... 16
- Shipyard..... VARD, Norway
- Delivery 2021

Stateroom Amenities

- Private balcony for all Staterooms and Suites
- Terrace for the Duplex Suites and the Owner's Suite
- Butler service and priority boarding: Owner's Suite, Duplex Suites, Privilege Suites, and Grand Prestige Suites
- Individually controlled air conditioning
- Stateroom layout: king-size bed, or twin beds, adjoining staterooms available (children welcome)
- Mini bar and 24-hour room service
- Satellite TV channels (availability dependent on navigation)
- Videos on demand
- Bose Bluetooth speaker
- Safe
- Selection of Diptyque bath products
- Dressing table, bathrobes, hairdryer
- Direct line telephone
- 110V American (two flat pins)/220V European (round sockets with two round pins)
- Inclusive Starlink Wifi internet access*

**Depending on the navigation areas, the Wifi may not be accessible for reasons beyond our control.*

FIVE REASONS TO SELL

LE COMMANDANT CHARCOT

1. The Ultimate Access to the Unreachable

Le Commandant Charcot is the only luxury passenger icebreaker capable of reaching the most remote and uncharted polar regions. It offers unrivaled access to destinations no other ship can reach, including first-ever Arctic winter sailings—giving your clients a chance to be true pioneers.

2. Exclusive, Immersive Polar Experiences

Le Commandant Charcot offers a 360° polar immersion, from navigating surreal ice landscapes to on-shore adventures led by polar experts. Guests enjoy rare wildlife encounters, scientific exploration, and authentic moments of discovery in environments few will ever experience.

3. Five-Star Luxury in the Heart of the Ice

Despite its extreme capabilities, *Le Commandant Charcot* delivers unmatched comfort and sophistication. With Alain Ducasse signature cuisine, a world-class spa, and warm, elegant interiors, it's the most refined way to explore the wildest places on Earth.

4. Purposeful & Sustainable Exploration

With LNG-electric hybrid propulsion, the ship sets new standards in environmentally responsible cruising. It also supports scientific research and local communities, offering clients an eco-conscious journey with lasting impact.

5. A Unique Selling Story for Your Clients

This is not a traditional cruise—it's a once-in-a-lifetime expedition that combines adventure, education, luxury, and exclusivity. Each journey is a new chapter in polar exploration—ideal for clients seeking something truly rare and meaningful.



Scan QR code to learn more and share with your clients.





Public Areas

LOBBY

1,905 sq. ft.

Reception/concierge desk, expeditions desk, Hospitality & Travel Manager office, boutique, image and photo desk

LOUNGES

- Main Lounge: 3,250 sq. ft.
Afternoon tea, lounge, live music on selected evenings
- Cigar Lounge: 301 sq. ft.
- Panoramic Bar & Lounge: 4,305 sq. ft.
- Open-air Bar

THEATER

Capacity: 270-276

Main show room for conferences and live entertainment on selected evening; state-of-the-art audio and video technology

RESTAURANTS

- Gastronomic Restaurant: 5,209 sq. ft.
Capacity: 284
Featuring the first Alain Ducasse restaurant at sea, with a menu designed by the 21-Michelin star chef himself, the elegant main dining room serves breakfast, lunch, and dinner and also features a fine wine cellar
- Lido (Grill Restaurant): 3,444 sq. ft.
Outside capacity, Grill: 62
Outside capacity, Lido: 70
Inside capacity: 150
Casual eating venue for breakfast, buffet lunch, and themed dinner

RECREATION / RELAXATION

- Fitness & Beauty Salon: Fitness room with elliptical machine, treadmills, and stationary bikes. Beauty Corner with hairdresser, massage rooms, sauna, snow room, nail salon
- Complimentary group classes: Water aerobics, aerobics, yoga, pilates, meditation, stretching, weightlifting, dance classes, track
- Personal Trainer: Available on a complimentary basis for Owner, Duplex, Privilege, and Grand Prestige Suites. Private classes will be given in the guest suite/room or in the gym
- Spa: Tailor-made spa treatments courtesy of Biologique Recherche – Paris
- Pool areas: Indoor Pool and Winter Garden; Outdoor Pool
- Public areas: Library; Medical Center

Activities Offered

- Kayaking
- Hiking
- Dog Sledding*
- Zodiac Cruising
- Snowshoeing
- Ice Fishing*
- Polar Plunge
- Nordic Trekking*

**Select itineraries, destination specific*

Le Commandant Charcot Accommodations

OWNER'S SUITE (115 sq.m/1,237 sq.ft + 186 sq.m/2,002 sq.ft private terrace with hot tub • balneo bathtub)

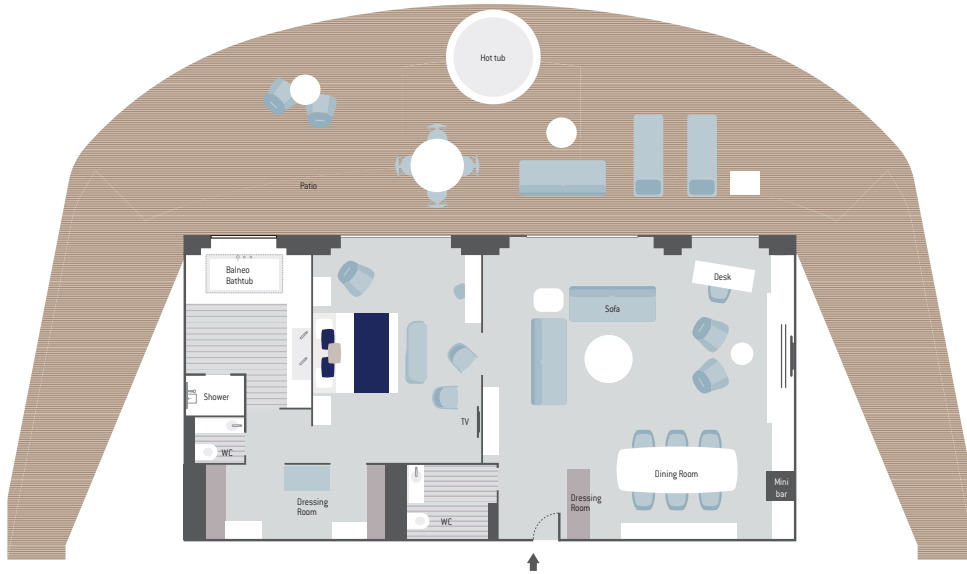

GRAND PRESTIGE SUITE (42 sq.m/452 sq.ft + 5 sq.m/54 sq.ft private balcony)

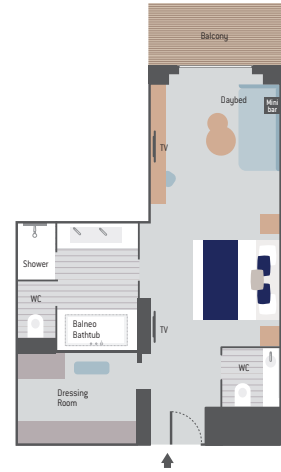

PRIVILEGE SUITE (48 sq.m/516 sq.ft + 12.5 sq.m/134.5 sq.ft private balcony • balneo bathtub)

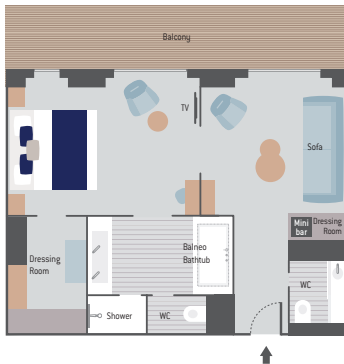

PRESTIGE SUITE (40 sq.m/430 sq.ft + 10 sq.m/107 sq.ft private balcony)

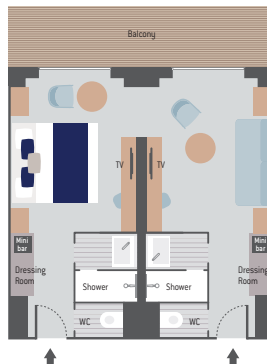

DUPLEX SUITE (94 sq.m/1,011 sq.ft + 26 sq.m/279 sq.ft private terrace with hot tub • balneo bathtub)



DELUXE SUITE (28 sq.m/301 sq.ft + 5 sq.m/53 sq.ft private balcony)



PRESTIGE STATEROOM (20 sq.m/215 sq.ft + 5 sq.m/53 sq.ft private balcony)





PONANT YACHTING

A NEW TRAVEL EXPERIENCE

PONANT EXPLORATIONS GROUP has embarked on a bold new chapter in luxury travel with a bespoke range of sea voyages aboard elegant, all-inclusive catamarans. This innovative experience blends the spirit of exploration and the highest standards of service with *Spirit of Ponant*, the flagship of this vision.

By late 2026, PONANT YACHTING will operate a fleet of three catamarans, with the launch of *La Désirade* and the *Spirit of Ponant II*, each accommodating nine to 12 guests.

Guests enjoy the personalized attention of a dedicated crew of four — Captain, first mate, chef, and hostess — along with refined cuisine, expertly curated wines and cocktails, and a full range of watersports, from paddleboarding and snorkeling to water skiing, wing foiling, Tiwal sailing, and Sublue diving.

Every moment is designed to offer an intimate and unforgettable sailing experience, tailored to families and groups of friends. Destinations include the Mediterranean, the Seychelles, the Caribbean, and French Polynesia.



Scan the QR code
to learn more.



FRENCH POLYNESIA'S DESTINATION EXPERT

In 2019, Paul Gauguin Cruises joined PONANT EXPLORATIONS GROUP, enhancing the portfolio of inspiring voyages on board small exploration ships.

Paul Gauguin Cruises operates the 330-guest m/s *Paul Gauguin*, providing a luxury cruise experience tailored to the unparalleled wonders of French Polynesia and the South Pacific. In addition to being voted the Best Small Cruise in *Condé Nast Traveler's* 2024 Readers' Choice Awards, Paul Gauguin Cruises also received Seatrade's 2024 Sustainability Initiative of the Year award for its "*Taote (doctor) Gauguin*" healthcare partnership with the French Polynesian government.

To learn more about Paul Gauguin Cruises, visit pgcruises.com.

To share The *Gauguin* Experience with your clients, visit inspires.to/pgcruises.

Paul Gauguin
CRUISES



A Member of

 **PONANT**
EXPLORATIONS GROUP



SERVICES ABOARD

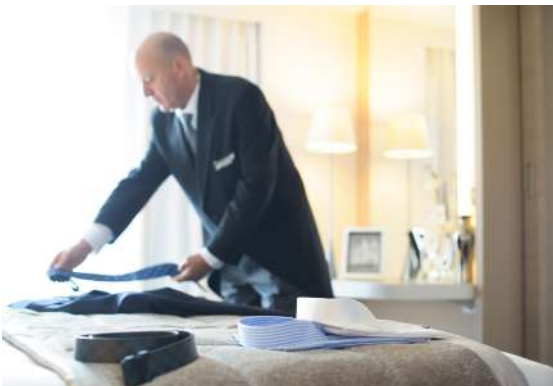

WI-FI: Complimentary and available throughout the ship.

TELEPHONE: Satellite communication is available at €6/minute.

SAFE: A private safe is located in each stateroom's wardrobe.

ROOM SERVICE: Complimentary 24-hour room service.

DAILY PROGRAM: Details about the next day's activities, enrichment programs, and dining options are delivered to staterooms each evening. Guests can also access the Daily Program via the PONANT App, available on the App Store and Google Play.

BUTLER SERVICE: Included for guests in all Suites on Deck 6 on *L'Austral*, *Le Boréal*, *Le Lyrial*, and *Le Soléal*; the Owner's Suite, Deluxe Suite, Privilege Suite, and Prestige Suite located on Deck 6 aboard the PONANT Explorers; and the Owner's Suite, Duplex Suites, Privilege Suites, and Grand Prestige Suites on *Le Commandant Charcot*.

ACCESSIBILITY: The Sisterships, PONANT Explorers, and *Le Commandant Charcot* are fully ADA compliant, with accessible staterooms, elevators, and lifts for stairs for easy access to all decks and public areas.



MEDICAL SERVICES: A doctor is available 24 hours a day for non-emergency care (fees may apply).

POSTAL SERVICE: Mail can be sent from the ship via Reception (postage charges apply).

PAYMENT: An onboard account is opened at reception for each guest. Guests can settle their bill with a credit card (Visa, American Express, MasterCard), cash, or traveler's checks. The currency on board is the Euro (US dollars also accepted).

RECEPTION / GUEST SERVICES: Reception is open 24 hours a day.

DRESS CODE: Casual resort attire is suitable during the day. Evenings are relaxed and elegant. For the Gala Evening, a dress for women and a jacket and tie for men are recommended but not required.

SPA & FITNESS:

- Sothys spa treatments, including facials, body treatments, and massages can be booked onboard, charges for spa services are added to stateroom bill
- Hammam and relaxation room
- Fitness center with treadmills, bikes, and panoramic views
- Outdoor swimming pool and sun deck

PHOTOGRAPHY & VIDEO SERVICES: A professional photographer and videographer are onboard to capture every moment. A "Best Of" CD and a DVD are available for purchase at the end of the voyage.

ENTERTAINMENT & ENRICHMENT:

- Expert-led lectures and presentations in the theater
- Live music in the lounges
- Library with books and magazines
- Photography and video service available

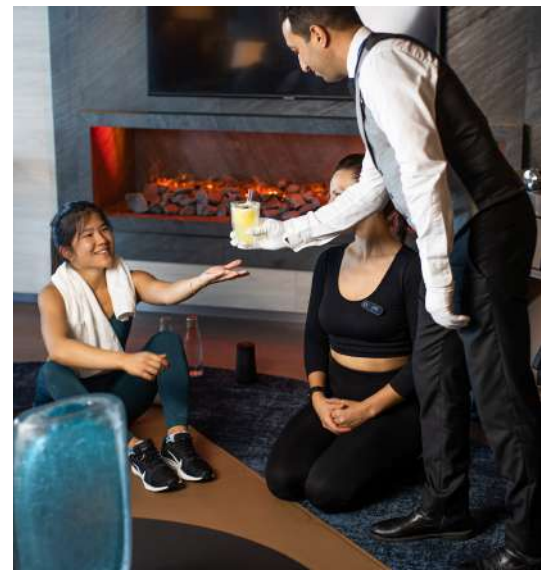



A REFINED TABLE

French-inspired gourmet cuisine created with Ducasse Conseil. Guests can choose between formal dining in the gastronomic restaurant or a more relaxed atmosphere at the grill.

Open seating is available for all meals.

THE FRENCH 'ART DE LA TABLE'

Our Chefs and their galley team interpret and share with our guests their passion for French culinary heritage, enriched by products and traditions from the countries visited. Fresh products and carefully selected ingredients, mature cheeses and a superb list of grand cru wines... all this combines to make each meal a feast for the eyes and the taste buds.

GASTRONOMIC RESTAURANT & GRILL RESTAURANT

Our ships offer two different dining concepts according to guests' desires. In the gastronomic restaurant, à la carte meals are served to the table. For lunch, there is a selection of dishes inspired by contemporary French brasserie cuisine. For dinner, guests are served refined cuisine in the finest French gastronomic tradition.

In the restaurant grill, the atmosphere is more relaxed with the buffet option. From breakfast until dinner, there are healthy, delicious, and refined options prepared by the team in the galley.

THE EXPERTISE OF DUCASSE CONSEIL

PONANT EXPLORATIONS joined forces with Ducasse Conseil, a catering center of excellence run by Alain Ducasse Entreprise, continuing its route to excellence aboard our ships. From the conception of the culinary offering to the training of the company's Chefs, this partnership aims to ensure that PONANT's culinary standards are as high as possible and to satisfy the exacting requirements of our guests.



PRIVATE GROUP DINING

According to your group, function, or event needs, we can accommodate special occasions in our various restaurant venues on board, subject to availability and prior confirmation. Our culinary team is able to accommodate special dietary needs and to enhance guests' dining experience with a customized menu.

INCLUSIVE BEVERAGE PACKAGE

Your clients' PONANT EXPLORATIONS voyage includes a broad selection of fine wine, champagne, beer, and liquor served throughout the journey. Soft drinks, mineral water, and juice are also available. Beer, soft drinks, juice, tonic water, and mineral water are available in each stateroom and suite's mini-bar. There is an additional charge for premium wines and liquors. PONANT enjoys an exclusive partnership with the French champagne house Veuve Clicquot and we are proud to serve the renowned label's spirits aboard all vessels. A Premium Beverage Package is available for purchase onboard for €25 per day per guest.

Alcohol service may be restricted in some countries.



EXCURSIONS & EXPLORATIONS

ZODIAC FLEET: Each ship is equipped with a fleet of Zodiac boats for guided explorations to remote coastlines and shallow water ports. Operated by a highly trained crew, Zodiacs allow guests to experience wildlife and landscapes up close.

EXCURSIONS: Curated shore excursions are available at every destination. One complimentary shore excursion per port or activity/landing ashore is included. We recommend you pre-book your clients included and/or optional experiences by email or telephone as early as two months before the start of the cruise and up to seven days before boarding. Spots are limited.



TOOLS FOR OUR
PARTNERS





HOW TO BOOK

To book, call our Travel Advisor Customer Care Team at 1-844-747-3281 or email USreservations@ponant.com, or register and log on to pro-us.ponant.com to access availability and hold a stateroom or suite. We provide a 48-hour courtesy hold on all options.

TRAINING

Visit ponantexplorer.com to have access to PONANT EXPLORATIONS Travel Advisor training. PONANT Explorer graduates qualify for up to three US \$100 e-gift cards for the first three bookings made within six months of certification. We also have a PONANT Explorer App, available on the App Store and Google Play.

SALES & MARKETING TOOLS

Flyers, offers, images, and videos can be found at ponantexplorer.com. For co-branded marketing pages, visit inspires.to/ponant.

ORDER BROCHURES

To order our inspiring travel brochures, visit us.ponant.com/brochures. Digital brochures are also available on the same link.

SOCIAL MEDIA

You can include PONANT EXPLORATIONS content in your social posts through Rallio. This platform makes it simple to access inspiring content you can share directly on your social channels, helping you save time, stay consistent, and engage your clients more effectively.

- If you are not yet enrolled with Rallio, visit ponant.rallio.com to sign up for free today.
- If you are already a Rallio user, add **PONANT EXPLORATIONS** to your selection by clicking on **Content** and **Feed**, so you can start sharing our content right away!

GROUPS



GROW YOUR GROUP BUSINESS WITH **PONANT EXPLORATIONS**

Group bookings mean increased revenue and reliable commissions and, with expert support throughout the process, you'll have everything you need to succeed. Is a group opportunity already on your radar?

Ask yourself:

- Do you already have a group of clients interested in sailing together?
- Is flexibility in pricing or allocation of staterooms important to you?
- Are you planning a family and friends reunion, themed voyage, seminar, milestone celebration or any type of getaway group?
- Would you like to earn complimentary berth(s) for the group leader or Tour Conductor (TC) credits?
- Do you know a 'pied piper' who wants to travel with their network?

No matter your answer, PONANT EXPLORATIONS' Group Program offers a solution tailored to your business model. Our small luxury ships create the perfect environment for team building, networking, and shared discovery—plus, our group fares are more competitive than individual rates!



WHY SELL GROUPS WITH PONANT

- **Boost your revenue** through group incentives
- **Earn complimentary stateroom(s)** with tour conductor credits
- **Choose the group model** that best fits your clients' travel style
- **Offer a luxury small-ship experience** they'll never forget

	TRADITIONAL GROUP	HYBRID GROUP	4 + 1 GROUP	PROMOTIONAL GROUP
Best For	Travel partners organizing small to mid-size groups who want guaranteed rates and blocked allotment of staterooms.	Larger groups needing guaranteed space and net pricing.	Small groups, targeted promotions are the fastest way to earn TC credit.	Travel Partners promoting a specific departure without taking inventory or short-term offers.
Allocation	Minimum of 8 to maximum of 18 staterooms allocated.	18+ staterooms allocated – cannot be released.	Up to 5 staterooms allocated.	Up to 8 staterooms allocated – No rooms are held, sell in to open inventory in specified categories. Subject to Space Availability.
Rates	5- 10% Savings with guaranteed rates.	Guaranteed rates and net pricing.	10 % Savings with guaranteed rates.	5-10% Savings with guaranteed rates until 180 days prior to departure.
Tour Conductor (TC) Credit	1:8: Earn 1 complimentary Tour Conductor (TC) stateroom for every 8 staterooms booked. Maximum 2 TC staterooms.	Do not earn a TC.	1:4: Earn 1 complimentary Tour Conductor (TC) stateroom for every 4 staterooms booked.	1:8 Earn 1 complimentary Tour Conductor (TC) stateroom for every 8 staterooms booked. Maximum 2 TC staterooms.
Payment Terms	Vary by sailing	Vary by sailing	Vary by sailing	Final payment due 90 days prior to sailing.
Deposit	Vary by sailing	25%	Vary by sailing	25% deposit due to confirm. Options can be held up to 72 hours without deposit.
Cancellation	Vary by sailing	Nonrefundable	Vary by sailing	FIT Terms
Restrictions	Not combinable with other offers. Available on select sailings.	Not combinable with other offers. Available on select sailings.	Not combinable with other offers. Available on select sailings.	Requires at least one booking within 3 months of rate activation. Not combinable with other offers. Available on select sailings. Subject to space availability.

Have a group idea? Contact your regional Director of Business Development to get started!



SPECIAL OFFERS

NO **SINGLE** SUPPLEMENT

Whether your clients are planning to embark on a solo adventure, travel with a group of friends, or seek some peace and serenity, they can enjoy their own space with on one of our several sailings with NO single supplement. There are over 100 departures for them to choose. To learn more, visit us.ponant.com/offers/no-single-supplement.

BACK-TO-BACK

Clients save with each consecutive itinerary: 1st consecutive voyage 10% off; 2nd 20% off; 3rd 30% off; 4th 40% off.

ONBOARD **BOOKINGS**

Clients who book on board receive a 5% savings that is combinable with the available PONANT Bonus Fare. All onboard bookings are attributed to the travel advisor of record, and the advisor is notified with a copy of the invoice and booking confirmation.



EARLY BOOKING **SAVINGS**

Published fares are inclusive of up to 30% PONANT Early Booking Savings, depending on availability. All itineraries are open for sale with the highest PONANT Bonus Savings, and the savings decrease as the ship books up, ensuring the best price for those who book early.

PONANT **YACHT CLUB**

As members of our loyalty program, your clients will receive personalized benefits, including discounts on future bookings, onboard credit, complimentary laundry service, priority boarding and even free voyage changes, depending on their tier.

Learn more at us.ponant.com/ponant-yacht-club



STATUS **MATCH**

If your clients are loyal members of another cruise line, they can match their current status with the PONANT Yacht Club and start enjoying a world of exclusive advantages from their very first sailing.



Scan QR code
to learn more.

Offers valid at time of printing and subject to change at any time.

FREQUENTLY ASKED QUESTIONS

What languages are spoken aboard?

All communications and announcements are in English and French. The crew are bilingual; they all speak English and French. Signs are in English and French. Excursions and explorations are offered in English and French. Select sailings are curated for English speaking travelers only.

Must single travelers always pay a supplement?

No, many voyages offer either a reduced supplement or no single supplement for solo travelers.

Are children welcome on the ship?

Children must be 8 years or older to board *Le Commandant Charcot*. Children must be 6 years or older to board an expedition (except aboard *Le Commandant Charcot*). Children must be 1 year or older on all non-expedition sailings. There is a limit of five children, aged 1 to 6 years, per departure. Kid's Club is available to children age 4 and up only, on select summer sailings in Europe.

During all expeditions, including to the Arctic and Antarctic, children must be completely autonomous during Zodiac landings and must immediately understand and respond to instructions given by the adults in charge. Their participation in such landings will be subject to approval from the Captain and the Expedition Leader, based on sea conditions and how difficult it is to land at each site visited. In any case, both on board and on land, children and young minors are the sole responsibility of their parent(s) or guardian(s).

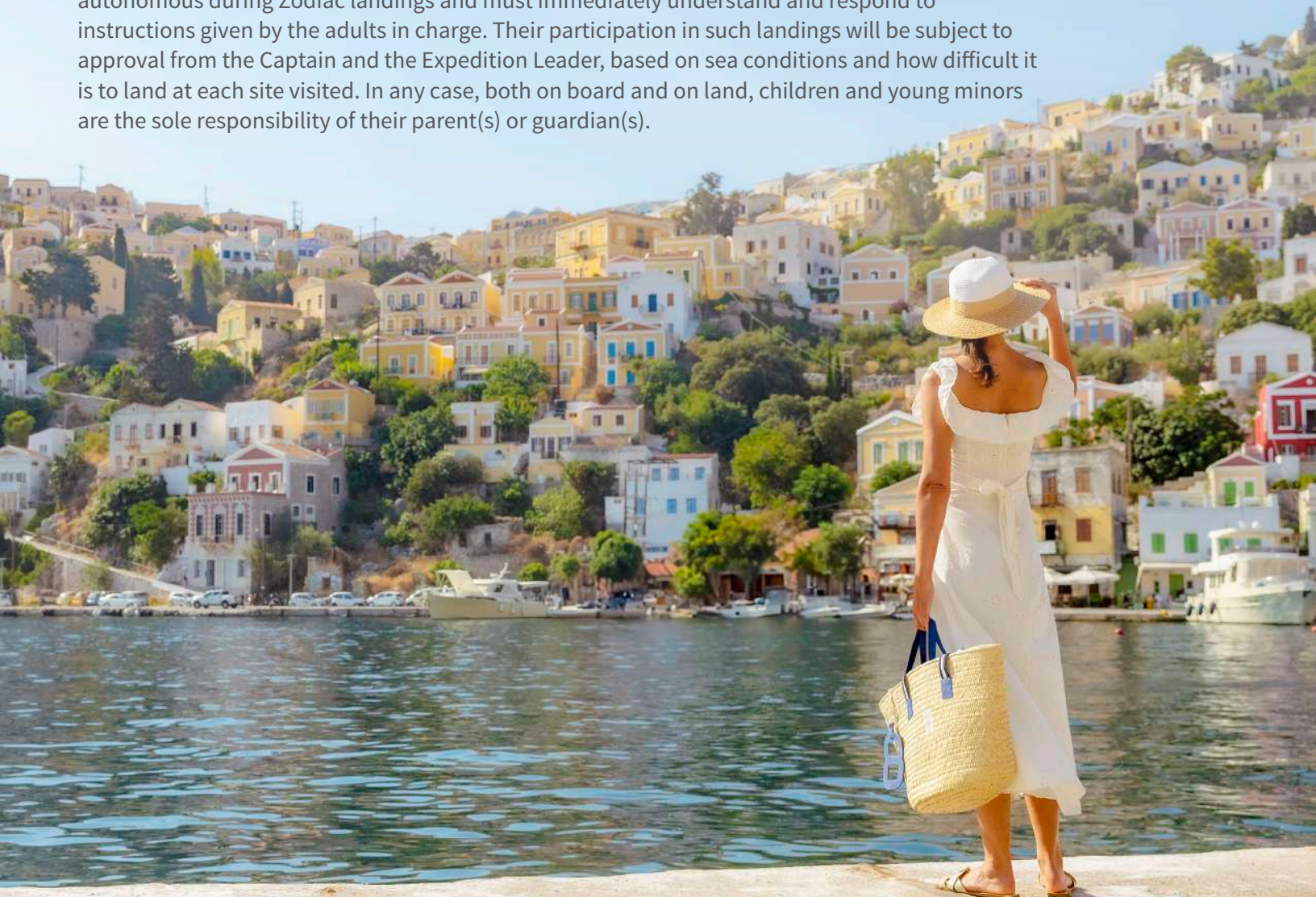

Do the power sockets on board comply with North American & European standards?

Yes, 220 volt alternating current at 50 Hz is supplied through power sockets that meet European standards. The electricity on board is 220 volt AC (European standard), with 110 volt AC (North American standard) in stateroom bathrooms. We recommend guests bring an adapter and a converter. For safety reasons, the use of personal irons and hair irons is not allowed.

Is smoking allowed on board?

All enclosed areas (lounge areas, dining room, staterooms, reception area, etc.) are non-smoking. Smoking is not permitted on balconies. Smoking is allowed in the ship's designated outdoor areas.

Is tipping compulsory?

Tipping is included in the fare. Additional tips to staff, crew, and spa therapists are at the discretion of the guest.

Is there a laundry service aboard the ships?

Yes, a steward or stewardess is available to take care of guests' laundry needs. Washing and ironing of clothing takes 24 to 48 hours. Same-day service is only available for ironing. Dry cleaning is not available. Laundry service is available for an additional charge.

Can purchases be made on board?

Gifts and souvenirs can be purchased in our boutique on board. Please note that the law requires us to close the boutique while we are at a port of call.

What's Included?

See Page 7

What's Not Included

- Airfare (other than charter flights on designated departures)
- Airport taxes (subject to modification)
- Ground services before and/or after the voyage
- Optional shore excursions, optional pre- and post-programs, and overlands
- Meals and beverages other than those specified above
- Personal expenses on board
- Travel insurance
- Beauty salon and spa services
- Medical services, consultations, and drug prescriptions
- Satellite telephone service
- Laundry services
- Passport and visa fees, if applicable

Can PONANT EXPLORATIONS book air, pre- and post-cruise hotels, and transfers?

Yes, a la carte and package options are available on select sailings. On select sailings transfers from the airport to the ship and/or from the ship to the airport on embarkation and/or disembarkation day may be included. On select sailings, flight(s) may be included, based on availability at the time of booking. Flight schedule is indicated on the electronic ticket included in the travel documents. Contact us for details.

What is the deposit policy?

A deposit of 25% of the fare is required within 72 hours of booking to confirm a reservation.

For latest updates on health and safety protocols contact us.



What is the final payment policy?

- Unless otherwise noted, final payment must be received up to 90 days prior to date of travel.
- Final payment must be received within 48 hours of booking for bookings made 89 to 30 days prior to sailing.
- For reservations made 29 days or less prior to sailings; full and final payment will be due at the time of booking.
- The cruise line reserves the right to cancel any booking not fully paid at final payment due date.
- Payment may be made by bank wire, personal check, American Express, Visa or MasterCard. Once a deposit is made, all changes are subject to an administrative/cancellation fee.
- For more details, visit: us.ponant.com/legal-information.

What is the cancellation policy?

Deposited reservations that are canceled are subject to the following charges:

- Within 15 days of deposit: No fee*
- 365 days or more prior to departure date: *\$250 Administrative Fee per guest, can be applied to a future booking within 12 months of cancellation date
- 364 to 211 days prior to departure date: 10% of full fare, per guest, can be applied to a future booking within 12 months of cancellation
- 210 to 91 days prior to departure date: 25% of full fare, per guest
- 90 days or less prior to departure date: 100% of full fare, per guest

There is no grace period after 90 days. Bookings not paid in full at 90 days (or 30 days with prior policy) are subject to cancellation. Final payment must be received 90 days prior to voyage departure date. Cancellation terms apply to the cruise fare only. Payments can be transferred to an alternative booking up to 120 days of sailing. Airfare and pre/post hotel stays are subject to fees depending on the cancellation date. Airline tickets are issued 75 days prior to sailing. A cancellation penalty will apply to all airline tickets cancelled after issuance. **Does not apply to bookings made within 90 days of sail date or that require full payment (whichever comes first).*

Can a direct booking be transferred to a Travel Advisor?

Bookings can only be transferred to a TA within 60 days of the original booking date. All transfer requests must be submitted in writing by the guest. This guideline applies only to bookings outside of 90 days prior to sailing.

For Full Terms and Conditions, visit us.ponant.com/terms-conditions

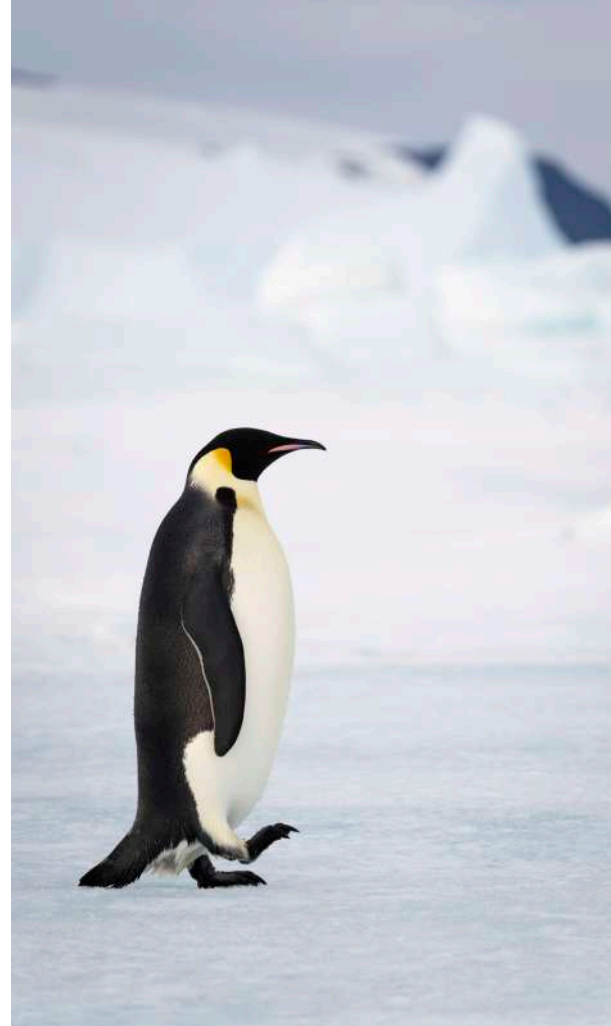

YOUR DEDICATED SALES TEAM



NICK ADOLPH
Director of Business Development,
Northwest USA
nadolph@ponant.com | (206) 949 0060



DALE WOODS
Director of Business Development,
Northeast and Mid-Atlantic USA
dwoods@ponant.com | (203) 356 5300



BOB MIESSLER
Director of Business Development,
Midwest USA
rmiessler@ponant.com | (630) 640 8300



BLISS BONAN
Manager of Business Development,
Tri-State USA
bbonan@ponant.com | (203) 554-9595

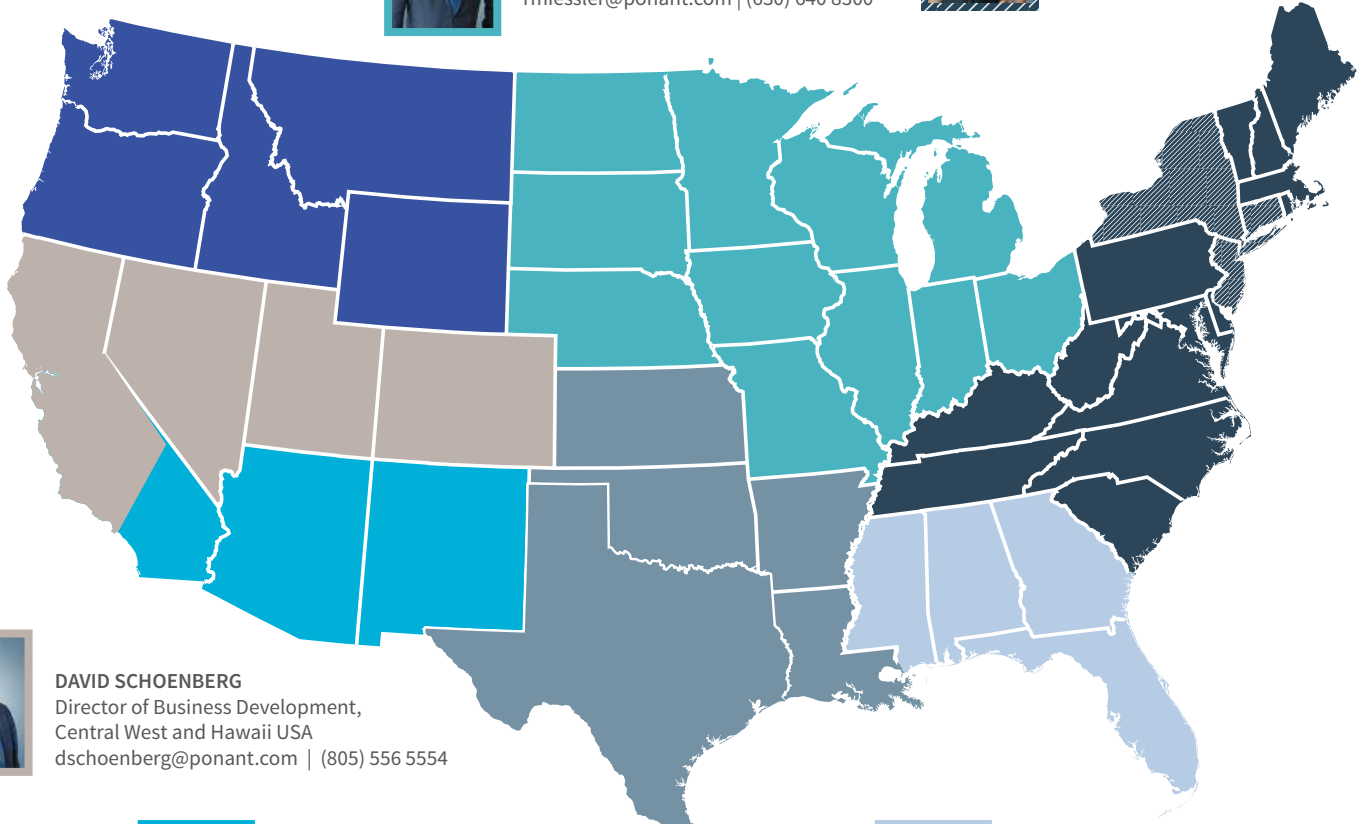

DAVID SCHOENBERG
Director of Business Development,
Central West and Hawaii USA
dschoenberg@ponant.com | (805) 556 5554



LISA GOURDINE
Director of Business Development,
Southwest USA
lgourdine@ponant.com | (323) 899-7904



XAVI SALINAS,
Director of Business Development,
Southeast USA
xsalinas@ponant.com | (954) 505 9333



TERESA SEVILLA
Director of Business
Development, South Central USA
tsevilla@ponant.com | (214) 529-9384



SUPPORTING YOU IN THE AMERICAS SO YOUR CLIENTS CAN **DISCOVER THE WORLD**

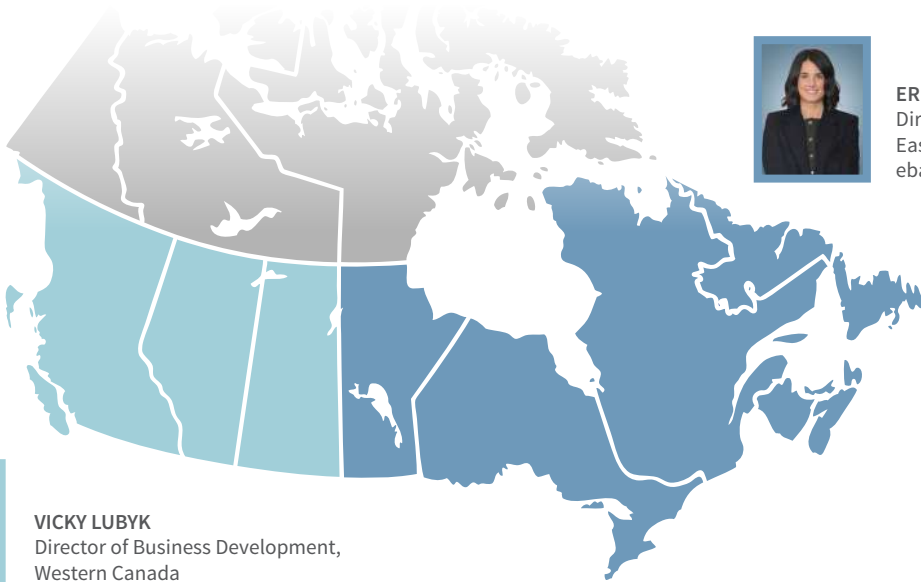

ERICA BARBOUR
Director of Business Development,
Eastern Canada
ebarbour@ponant.com | (514) 794 6784



VICKY LUBYK
Director of Business Development,
Western Canada
vlubyk@ponant.com | (403) 477 3215



JOSE RONCERO
Director of Business Development,
Latin America & Caribbean
jroncero@ponant.com | +52 (553) 485 9818



ELLEN MCILVAINE
Vice President of Sales,
Americas
emcilmvaine@ponant.com
(208) 921-5346



SANDRA LOWE-BROWN
Manager, Inside Sales,
Americas
slowebrown@ponant.com



facebook.com/PonantExplorationsEN



[@ponant](https://instagram.com/ponant)



[ponantcruises](https://pinterest.com/ponantcruises)



[PonantCruises](https://youtube.com/PonantCruises)

[#PONANTEXPLORATIONS](https://twitter.com/PONANTEXPLORATIONS)
[#ExploreToInspire](https://twitter.com/ExploreToInspire)
[#DiscoverYourInnerExplorer](https://twitter.com/DiscoverYourInnerExplorer)



TO BOOK, CALL OUR TRAVEL ADVISOR CUSTOMER CARE TEAM AT

+1 844 747 3281

us.ponant.com

ponantexplorer.com

inspires.to/ponant

ponant.rallio.com